

Stainless Steel Louvre. (Small Blade) Type: SBL-SS

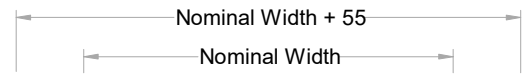
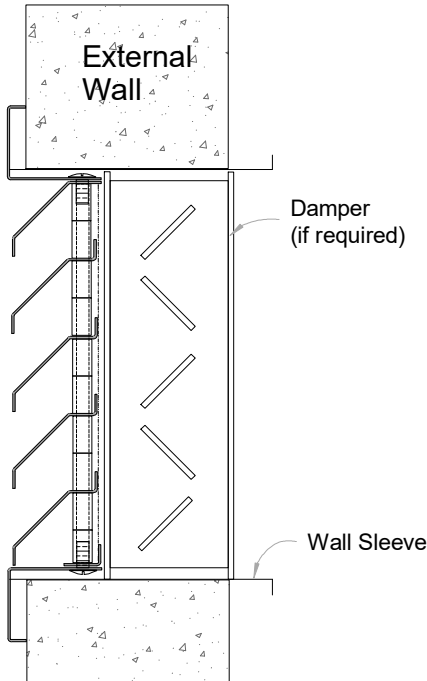

APPLICATION:

The SBL-SS is a small blade Stainless Steel Weather Louvre which has been specifically designed for use in Walls where conventional aluminium or mild steel products are not desirable either for hygiene, corrosion resistancy or perhaps just simply for quality & aesthetic reasons.

This product by nature of the manufacturing process remains robust and resistant to many chemicals & cleaning fluids etc. Applications such as Laboratories, hospitals, pharmaceutical and industrial premises as well as wide range of marine facilities.

SPECIALS:

Due to the flexible manufacturing process it is possible to provide many different blade and frame arrangements in terms of thickness and angle as well as depth for increased strength. Alternative shapes are also possible such as circular, arched, triangular and hexagonal for example.

STANDARD:

Our standard construction is of 304 grade Stainless Steel with a Brush finish known as Dull Polish. Bird Mesh is fitted as standard, Insect Mesh is optional.

MATERIALS:

Stainless Steel 304 or 316 DP1 marine grade with a minimum thickness of 1mm depending louvre dimensions.

CONSTRUCTION:

Pressed formed frame & blades with rod and spacer assembled core providing added rigidity to the frame. Alternative materials and thicknesses are available.

ALTERNATIVE FINISH:

Polyester Powder Coated. (for mild steel or Aluminum option)
Galvanized after manufacture.
Mill finish Stainless Steel.
Polished Stainless Steel.
Polished Brass.

DIMENSIONS:

All dimensions are in mm.
Width and height can be manufactured to any size.
Overall depth can be manufactured to 25, 30, 40 & 50.
The "Pitch" dimension is 41 as standard however can be adjusted to any dimension to suit the clients requirements.

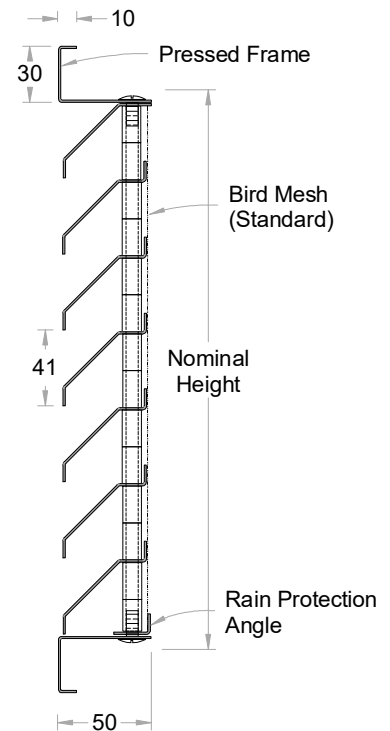

OPTIONS:

Removable & Hinged cores.
Various frame types & Concealed fixings are available.
Filter frames & Insect mesh.
Volume control & Fire dampers.
Fire rated & standard plenums / Wall Sleeves.

SPECIFICATION:

The Flanged frame is to be manufactured from 1mm thick Dull Polished Stainless Steel sheet press formed from a single section of material to give a complete jointless corner on the face flanges.
The 45 Deg core is 45-50% free area and manufactured from matching material of the frame. The grain of the brush finish of the core is to be the same direction as the frame.
The core is to be securely fixed to the frame using rods and spacers. Screw Holes (countersunk or flat) shall be specified if required.
The Stainless Steel Grade shall also be specified i.e. 304 or 316 etc.